

## OFFICE SPACE FOR LEASE

**SUITE 110 - 3,970 SF - Available**  
**SUITE 130 - 5,011 SF - Available**

- Class "A" office building
- 3 large private perimeter offices with large open cubicle area, IT room, small conference
- Furniture and Cubicles in place
- Monument Signage
- Ample Parking (5.25 spaces per 1,000 SF)
- Direct access to SR 408 (East West Expressway)
- Multiple Shared Amenities (Conference rooms, training rooms, fitness center, break lounge)
- Asking Rent: \$26.00 PSF FS



The information contained herein has been obtained from sources deemed reliable, however, HRS makes no guarantees, warranties or representation as to its completeness or accuracy thereof. The presentation of this property is submitted subject to errors, omissions, change of price or conditions, prior to sale or lease or withdrawal without notice.

**Josh Smith**  
jsmith@harbertrealty.com  
407.377.4050

**Justin Walker**  
jwalker@harbertrealty.com  
407.377.4042

HarbertRealty.com  
407.377.4050  
2450 Maitland Center Pkwy  
Suite 200  
Maitland, FL 32751

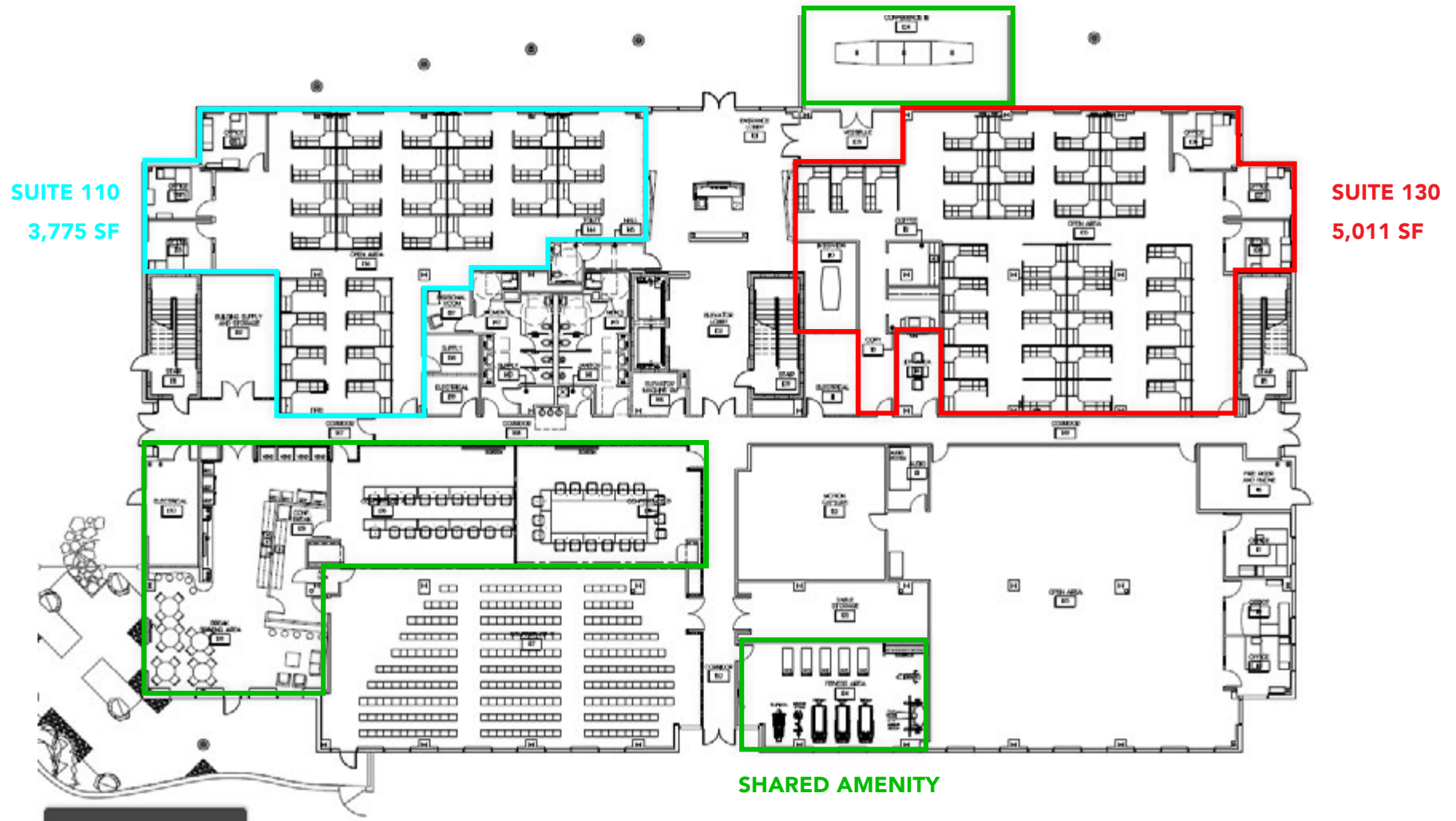





#### **BREAK ROOM**

Tenants will have access to the first-floor break room which offers soft comfortable seating, creating a true on-site lounge. The break room offers additional high-top seating and access to the outdoor patio area for a relaxed environment. Tenants can make use of the microwaves, dishwasher, four full-size refrigerators, and vending machines. The break-room also contains a television and speakers with audio input.

#### **FLEXIBLE CONFERENCING, CORPORATE EVENTS & TRAINING**

Tenants shall have access to the building's large training, event, & conference center. This shared amenity seats up to 350 people and can be demised and configured in multiple ways to accommodate large and break-out sessions of a variety of sizes. Tenants can conduct large scale assemblies and corporate events utilizing a full audiovisual package complete with three 164-inch projection screens, podium, and a suite of wireless microphones. An attached kitchen and food prep/staging area with refrigerators is ideal for hosting corporate or catered events.



#### **OUTDOOR PATIO**

In addition to the break room, Tenants can relax in the connected outdoor patio. The patio is ideal for enjoying breaktime in a peaceful outdoor environment of trees, landscaping, water feature, and plenty of seating within this unique paved patio space.

#### **EXECUTIVE CONFERENCING**

Tenants with executive-level conference needs or C-level meetings may utilize this state-of-the-art, first-floor Executive conference room, which can accommodate up to 25 people. A fully-furnished conference room, it includes audio-visual elements such as overhead speakers and a 110 inch framed projector screen, in addition to plush leather seating, glass writing board, and side counters, cabinetry, and mini-fridge for staging refreshments. A vestibule entry directly from the first floor lobby can accommodate food and refreshments outside of the conference room space.





**CORPORATE EVENT CENTER**

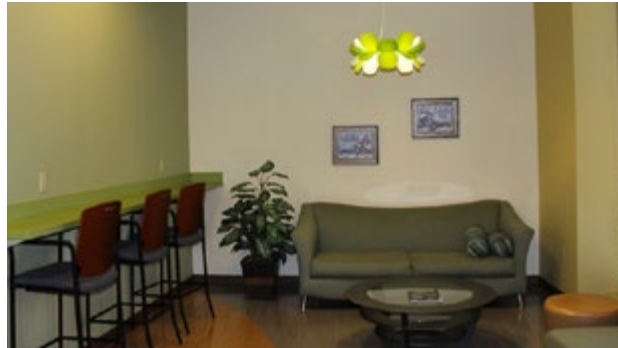

**BREAK ROOM**



**EXTERIOR**



**CORPORATE EVENT CENTER**



**RECEPTION**



**EXTERIOR**